

# A-Anchor System

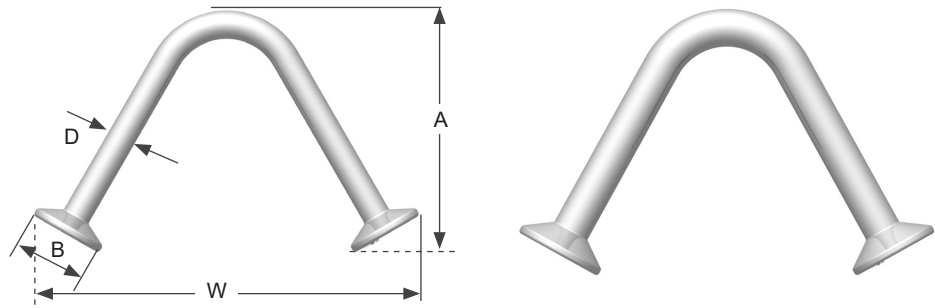

## .444" And .671" A-Anchors

CONAC A-Anchors are available in standard finish galvanized and self color.



ITEM CODE	SLAB MIN. THICKNESS	SWL TENSION	SWL AT 90° SHEAR	END DISTANCE
4CA44	4"	3200	5800	9"
5CA44	5"	3860	7710	11"
6CA44	6"	4460	9460	15"
5CA67	5"	4560	8430	11"
6CA67	6"	7320	15780	15"
8CA67	8"	10830	18850	20"

ITEM CODE	DEPTH (A)	ANCHOR WIDTH (W)	BODY DIA. (D)	BASE DIA. (B)	PANEL DEPTH
4CA44	3-1/8"	5-1/4"	0.444"	1-1/8"	4"
5CA44	3-3/4"	6"	0.444"	1-1/8"	5"
6CA44	4-3/4"	7-3/8"	0.444"	1-1/8"	6"
5CA67	3-3/4"	6-7/16"	0.671"	1-5/8"	5"
6CA67	4-3/4"	7-3/8"	0.671"	1-5/8"	6"
8CA67	6-3/4"	9-3/4"	0.671"	1-5/8"	8"

Note: Safe working loads based on approximate 4:1 safety factor with a minimum concrete strength of 4,000 psi. For use as pulling iron load may be increased by up to 33% with a Safety Factor of 3:1.

## A-Anchor Rubber Recess Formers

A Anchor Rubber Recess Formers are manufactured in 90° angles. The recess former sets the top of the anchor 3/4" below the surface of the concrete.

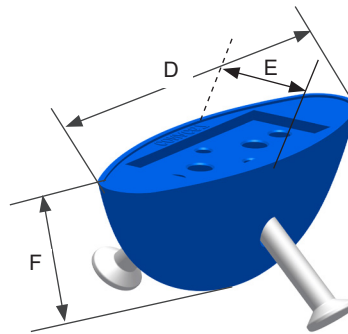

ITEM CODE	D	E	F	COLOR
CRRF9044	8"	3"	3.5"	Blue
CRRF9067	8"	3"	3.5"	Green

## A-Anchor Plastic Recess Formers

A-Anchor single use plastic recess formers attach to mesh or rebar cages. Patent # 8,024,896

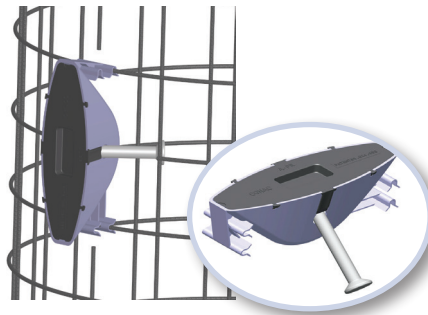

ITEM CODE	D	E	F	QTY/BOX
A-PRF-44	9"	3"	3.25"	110 PCS
A-PRF-1-18	9"	3"	3.25"	110 PCS

## A-Anchor with Clip

Welded clips allow mounting to wire mesh cage. Available in various clip sizes and configurations.

