

Lifting System



Coil Lifting System

Straight Coil Loop Inserts

Coil is welded to a single wire closed loop.

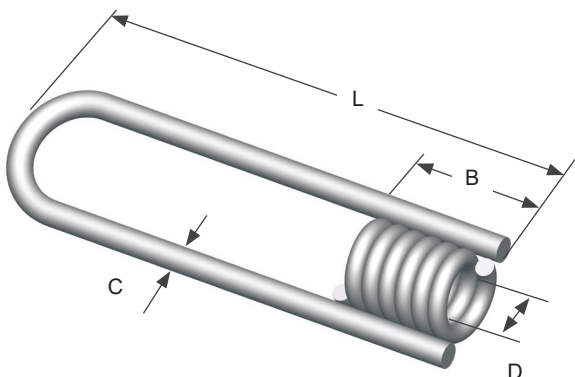

ITEM CODE	THREAD (D)	INSERT LENGTH (L)	BODY LENGTH (B)	WIRE DIA. (C)	SWL (LBS)	EDGE DIST.
C16B0540	1/2" coil	4"	1-3/16"	0.306"	2250	5"
C16B0560	1/2" coil	6"	1-3/16"	0.306"	3000	7"
C16B0524	1/2" coil	24"	1-3/16"	0.306"	3000	7"
C16B07540	3/4" coil	4"	1-5/8"	0.375"	2250	5"
C16B07560	3/4" coil	6"	1-5/8"	0.375"	3750	7"
C16B1040	1" coil	4"	2-1/16"	0.375"	3750	5"
C16B1050	1" coil	5"	2-1/16"	0.375"	3750	6"
C16B1060	1" coil	6"	2-1/16"	0.375"	3750	7"
C16B1080	1" coil	8"	2-1/16"	0.375"	3750	9"

Safe working loads based on approximate 4:1 Safety Factor in 3,000 psi normal weight concrete.
 CONAC does not recommend using 1/2" inserts for lifting.

Double Flared Coil Loop Inserts

Second coil loop adds significant capacity in both shear and tension.

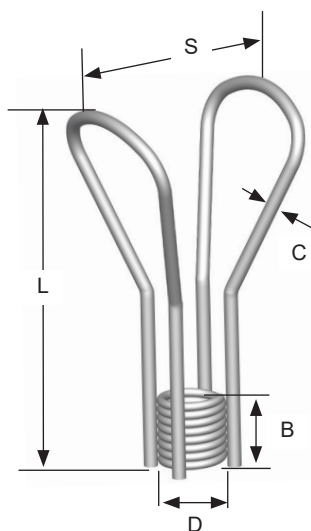

ITEM CODE	THREAD (D)	INSERT LENGTH (L)	BODY LENGTH (B)	WIRE DIA. (C)	SWL (LBS)	S
C17B1012 HD	1"	12"	2-1/16"	0.440"	13500	5-3/4"
C17B-1-1/4" X 12 HD	1-1/4"	12"	2-3/8"	0.440"	13500	5-3/4"
C17B 1-1/2" x 12 HD	1-1/2"	12"	2-9/16"	0.440"	13500	5-3/4"

Safe working loads based on approximate 4:1 Safety Factor in 3,000 psi normal weight concrete.

Single Flared Coil Loop Inserts

Coil is welded to a singled flared wire loop strut.

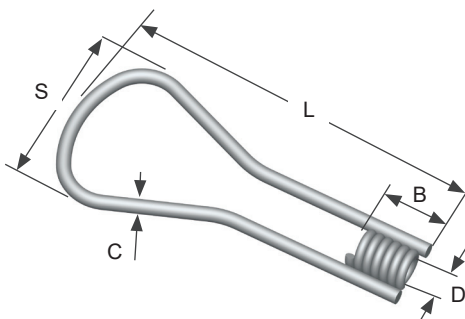

ITEM CODE	THREAD (D)	INSERT LENGTH (L)	BODY LENGTH (B)	WIRE DIA. (C)	LOOP SPREAD (S)	SWL (LBS)	SUGGESTED EDGE DISTANCE
C18B0540	1/2"	4"	1-3/16"	0.306"	3-1/8"	3000	6"
C18B0512	1/2"	12"	1-3/16"	0.306"	3-1/8"	3000	20"
C18B07540	3/4"	4"	1-5/8"	0.375"	3-1/2"	3000	6"
C18B07560	3/4"	6"	1-5/8"	0.375"	3-1/2"	4750	9"
C18B0759 HD	3/4"	9"	1-5/8"	0.440"	5-5/8"	6640	15"
C18B07512HD	3/4"	12"	1-5/8"	0.440"	5-5/8"	6640	20"
C18B109 HD	1"	9"	2-1/16"	0.440"	5-5/8"	8000	15"
C18B1012HD	1"	12"	2-1/16"	0.440"	5-3/4"	8000	20"

Safe working loads based on approximate 4:1 Safety Factor in 3,000 psi normal weight concrete.
 CONAC does not recommend using 1/2" inserts for lifting.

Thin Slab 4 Leg Coil Inserts

Very versatile insert intended for use for lifting and handling thin slab concrete. The coil is welded to four "L" shaped legs.

ITEM CODE	THREAD (D)	INSERT LENGTH (L)	BODY LENGTH (B)	WIRE DIA. (C)	SPREAD (S)	SWL (LBS)	STRUTS
C53C0753	3/4"	3"	1-5/8"	0.375"	7-1/16"	2000	4
C53C07540	3/4"	4"	1-5/8"	0.375"	7-1/16"	2000	4
C53C0755	3/4"	5"	1-5/8"	0.375"	7-1/16"	2500	4
C53C1035	1"	3-1/2"	2-1/16"	0.375"	9-3/8"	3000	4
C53C1040	1"	4"	2-1/16"	0.375"	9-3/8"	3000	4
C53C1055	1"	5-1/2"	2-1/16"	0.375"	9-3/8"	3000	4
C53C10612 W/6	1"	6-1/2"	2-1/16"	0.375"	9-3/8"	3000	6
C53C1240	1-1/4"	4"	2-1/16"	0.375"	9-3/4"	3000	4

Safe working loads based on approximate 4:1 Safety Factor in 3,000 psi normal weight concrete.

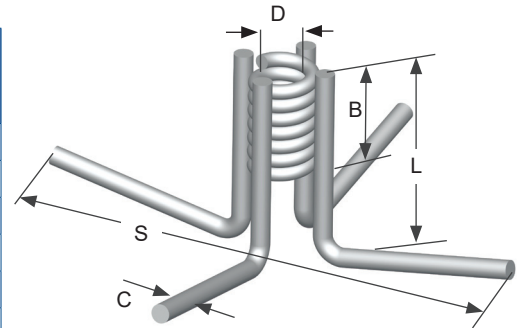

Expanded Coil Inserts With 2, 4 and 6 Struts

Coil is welded to dual flared wire loop struts. Intended for use in heavy anchorage conditions. Inserts located at the end of either two or four wire connecting struts.

ITEM CODE	STRUTS	THREAD (D)	INSERT LENGTH (L)	BODY LENGTH (B)	WIRE DIA. (C)	OVERALL WIDTH (G)	SWL (LBS)
C56C-3/4	2	3/4"	4-1/2"	1-5/8"	0.440"	2-1/8"	4250
C56C-1	2	1"	5-1/2"	2-1/16"	0.440"	2-3/4"	6250
C58C-1-1/4	4	1-1/4"	7-1/2"	2-3/8"	0.440"	3"	12000
C60C-1-1/2	6	1-1/2"	9-1/2"	2-9/16"	0.440"	3"	16250

Safe working loads based on approximate 4:1 Safety Factor in 3,000 psi normal weight concrete.

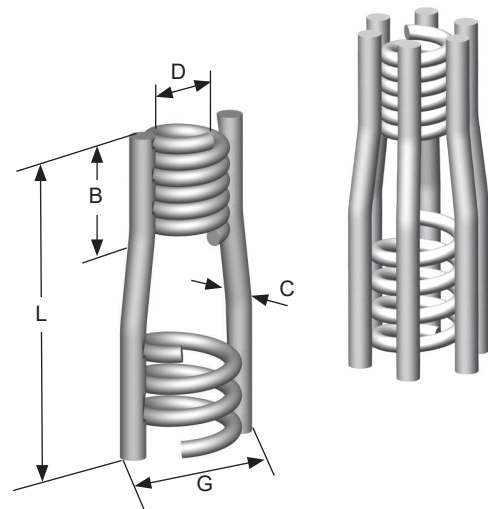

Coil Lifting System



Flared Thin Slab Coil Insert - Wing Nut Style

Coil is welded to two "L" profile closed loop wire struts. Intended for handling thin slab concrete sections. Available with manual weld.

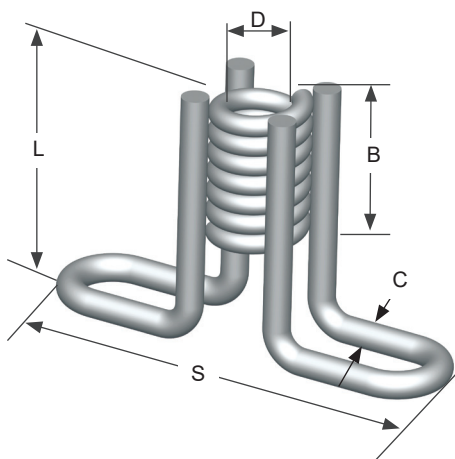

ITEM CODE	THREAD (D)	INSERT LENGTH (L)	BODY LENGTH (B)	WIRE DIA. (C)	SPREAD (S)	SWL (LBS)	SUGGESTED EDGE DISTANCE
C63C05175	1/2"	1-3/4"	1-3/16"	0.223"	4-1/2"	950	4"
C63C0752516	3/4"	2-5/16"	1-5/8"	0.375"	4-7/8"	2000	5"
C63C07530	3/4"	3"	1-5/8"	0.375"	4-7/8"	2980	8"
C63C075312	3/4"	3-1/2"	1-5/8"	0.375"	4-7/8"	3400	10"
C63C07540	3/4"	4"	1-5/8"	0.375"	4-7/8"	3400	10"
C63C102516	1"	2-5/16"	2-1/16"	0.375"	5-1/4"	2000	5"
C63C1030	1"	3"	2-1/16"	0.375"	5-1/4"	2980	8"
C63C10350	1"	3-1/2"	2-1/16"	0.375"	5-1/4"	3400	10"
C63C1040	1"	4"	2-1/16"	0.375"	5-1/4"	3400	10"
C63C10412	1"	4-1/2"	2-1/16"	0.375"	5-1/4"	4750	10"

Safe working loads based on approximate 4:1 Safety Factor in 3,000 psi normal weight concrete. CONAC does not recommend using 1/2" inserts for lifting.

Single Pick Up Coil Inserts

Used for face lifting of flat wall panels and slabs. Available in additional lengths and thread sizes. Optional .444 rod diameter will provide 80 Kips load capacity. Available with manual weld.

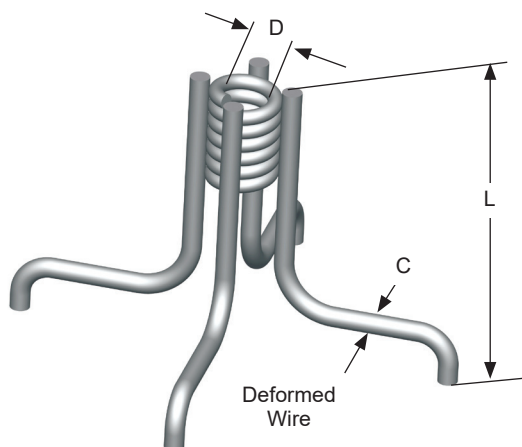

ITEM CODE	THREAD (D)	INSERT LENGTH (L)	WIRE DIA. (C)	SWL (LBS)
C1T10550	1"	5-1/2"	0.375"	3750
C1T10650	1"	6-1/2"	0.375"	5000
C1T1070	1"	7"	0.444"	6750
C1T10750	1"	7-1/2"	0.375"	6480
C1T10950	1"	9-1/2"	0.375"	8100

Safe working loads based on approximate 4:1 Safety Factor in 3,000 psi normal weight concrete.

Coil Lifting System



Coil Ties

Strong and versatile coil tie insert intended for lifting. The coil is welded to two or four struts. Also available with Shear Bar. Coil Ties using .444 rods are manually welded for additional strength.

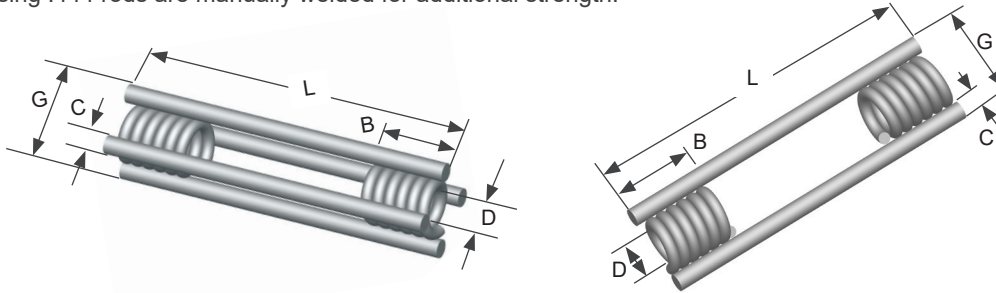

ITEM CODE	STRUTS	THREAD (D)	INSERT LENGTH (L)	BODY LENGTH (B)	WIRE DIAMETER (C)	OVERALL WIDTH (G)	SWL (LBS)
CT2-3/4X5	2	3/4"	5"	1-5/8"	0.375"	1-5/8"	4250
CT2-3/4X6	2	3/4"	6"	1-5/8"	0.440"	1-5/8"	4500
CT2-3/4X8	2	3/4"	8"	1-5/8"	0.440"	1-5/8"	6000
CT2-1X6	2	1"	6"	2-1/16"	0.440"	2-3/8"	6000
CT2-1-1/4X8	2	1-1/4"	8"	2-1/16"	0.440"	2-1/2"	7500
CT4-3/4X6	4	3/4"	6"	1-5/8"	0.440"	1-3/4"	6000
CT4-1X6	4	1"	6"	2-1/16"	0.440"	2-3/8"	6000
CT4-1X8	4	1"	8"	2-1/16"	0.440"	2-3/8"	9000
CT4-1X12	4	1"	12"	2-1/16"	0.440"	2-3/8"	9000
CT4-1X15	4	1"	15"	2-1/16"	0.440"	2-3/8"	9000
CT4-1-1/4"X8	4	1-1/4"	8"	2-3/8"	0.440"	2-1/2"	9000
CT4-1-1/4"X12	4	1-1/4"	12"	2-3/8"	0.440"	2-1/2"	13500
CT4-1-1/4"X18	4	1-1/4"	18"	2-3/8"	0.440"	2-1/2"	13500
CT4-1X12S	4	1"	12"	2-1/16"	0.440"	2-3/4"	9000
CT4-1X15S	4	1"	15"	2-1/16"	0.440"	2-3/4"	9000
CT4-1X18S	4	1"	18"	2-1/16"	0.440"	2-3/4"	9000
CT6-1-1/4X10	6	1-1/4"	10"	2-3/8"	0.440"	2-3/4"	12000

Safe working loads based on approximate 4:1 Safety Factor in 3,000 psi normal weight concrete.

Straight Criss-Cross Coil Inserts

Ideal for edge lifting applications due to the high strength provided by the 4 struts design.

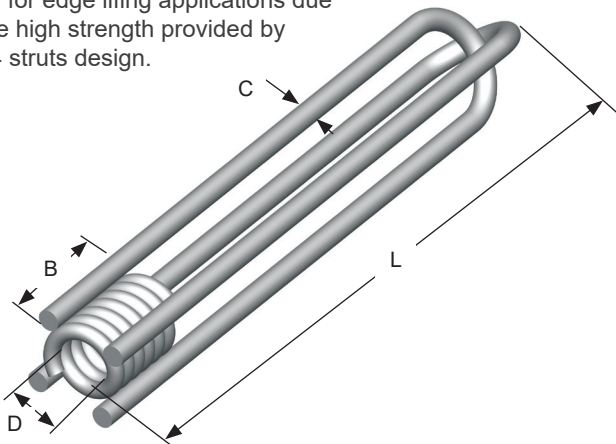

ITEM CODE	THREAD (D)	INSERT LENGTH (L)	WIRE DIA. (C)	BODY LENGTH (B)	SWL (LBS)
FCC 3/4X9	3/4"	9"	0.375"	1-5/8"	3,700
FCC1X12HD	1"	12"	0.440"	2-1/16"	6,500
FCC1-1/4X12HD	1-1/4"	12"	0.440"	2-3/8"	7,500

Safe working loads based on approximate 4:1 Safety Factor in 3,000 psi normal weight concrete.

Coil Lifting System



Waved Tail Anchors (Coil Thread)

Extended waved tail provides exceptional tensile capacity in thin panels. Can also be used in shear with addition of a shear bow.

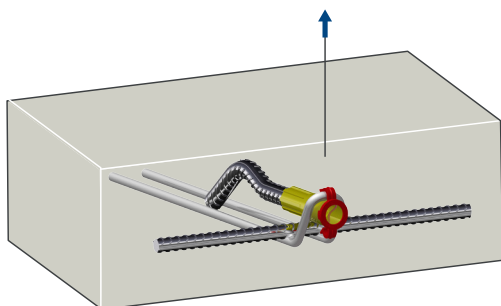

Shear load can be increased by using shear bow reinforcement.

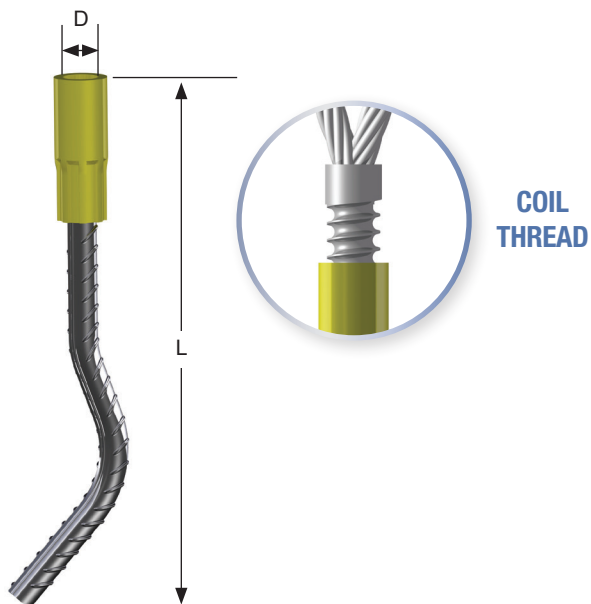

TON	ITEM CODE	ANCHOR LENGTH (L)	THREAD SIZE (D)	MIN. END DISTANCE	MIN. PANEL THICK. TENSION	MIN. PANEL THICK. SHEAR	SWL SHEAR (LBS)	SWL TENSION (LBS)
2	WTC 3/4"	10-1/4"	3/4"	11"	3-1/2"	4-1/2"	2000	4000
3.5	WTC 1"	15-1/2"	1"	14"	4-3/4"	6"	3500	7000
8	WTC 1-1/4"	25"	1-1/4"	20"	7"	9-1/2"	8000	16000

Safe working loads based on approximate 4:1 Safety Factor in 2,200 psi normal weight concrete.

Compatible with coil lifting accessories.

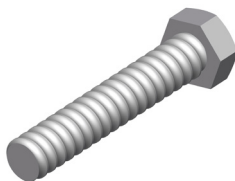

Coil Lifting System



Standard Coil Nuts (CN-13)

Available in plain and plated finish.

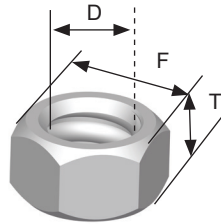

ITEM CODE	THREAD (D)	THICK. (T)	ACROSS FLAT (F)	SWL TENSION (LBS)
CN05	1/2"	1/2"	7/8"	1800
CN075	3/4"	5/8"	1-1/8"	3600
CN10	1"	1"	1-1/2"	7200
CN1025	1-1/4"	1-1/4"	2"	14400
CN1050	1-1/2"	1-1/2"	2-3/8"	19000

Note: In applications with Coil Bolts or Rods, the published loads assume usage of two Coil Nuts locked closely together. Safe working loads based on approximate 5:1 Safety Factor.

Heavy Duty Coil Nuts (CN-25)

Available in plain and plated finish.

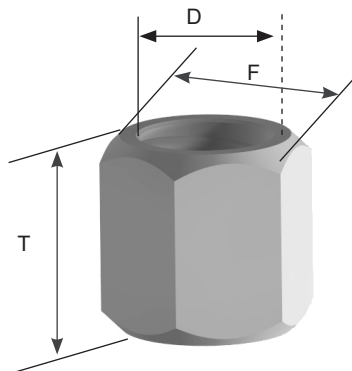

ITEM CODE	THREAD (D)	THICK. (T)	ACROSS FLAT (F)	SWL TENSION (LBS)
CN25-75	3/4"	1-1/2"	1-1/4"	7200
CN25-10	1"	2"	1-5/8"	15000
CN25-1025	1-1/4"	2-1/2"	2"	22500
CN25-1050	1-1/2"	3"	2-3/8"	27000

Safe working loads based on approximate 5:1 Safety Factor.

Coil Bolts

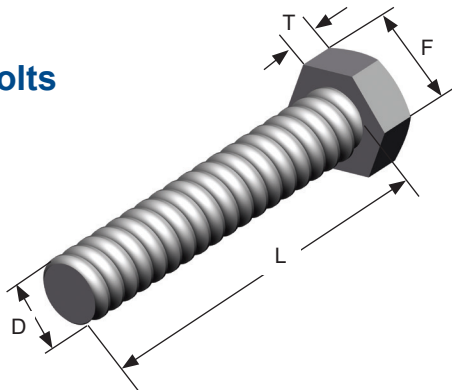

ITEM CODE	THREAD (D)	LENGTH (L)	HEAD THICK. (T)	ACROSS FLATS (F)	TENSILE STRENGTH (LBS)
CB0515	1/2"	1-1/2"	3/8"	3/4"	2700
CB0520	1/2"	2"	3/8"	3/4"	2700
CB0525	1/2"	2-1/2"	3/8"	3/4"	2700
CB0530	1/2"	3"	3/8"	3/4"	2700
CB0540	1/2"	4"	3/8"	3/4"	2700
CB0550	1/2"	5"	3/8"	3/4"	2700
CB0560	1/2"	6"	3/8"	3/4"	2700
CB07520	3/4"	2"	1/2"	1-1/8"	4600
CB07525	3/4"	2-1/2"	1/2"	1-1/8"	4600
CB07530	3/4"	3"	1/2"	1-1/8"	4600
CB07540	3/4"	4"	1/2"	1-1/8"	4600
CB07550	3/4"	5-1/2"	1/2"	1-1/8"	4600
CB07560	3/4"	6"	1/2"	1-1/8"	4600
CB1040	1"	4"	5/8"	1-1/2"	7200
CB102580	1-1/4"	8"	3/4"	1-7/8"	13500

Safe working loads based on approximate 5:1 Safety Factor. Other sizes available upon request.

CAUTION: Coil Bolts should always be long enough to penetrate **at least 3/4"** beyond the coil insert threads.

3/4" COIL BOLT (SWL)	
Tension	Shear
4600 LBS	3080 LBS
Minimum Coil Penetration 2-1/2"	
Bolt Length	Min. Thread Length
3"	2-7/8"
4"	3-7/8"

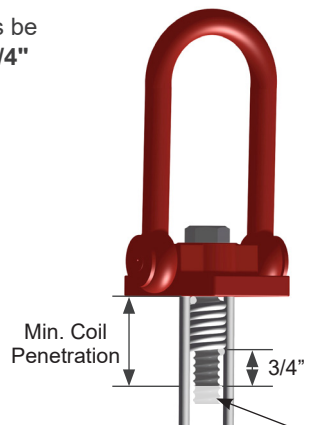

Sufficient void to be created beyond Coil Bolt using CONAC Plastic Coil Protector (PCP) or setting bolt.

Coil Lifting System



Coil Rods

All CONAC coil rods are made from high tensile steel. Available in 6' and 12' lengths.

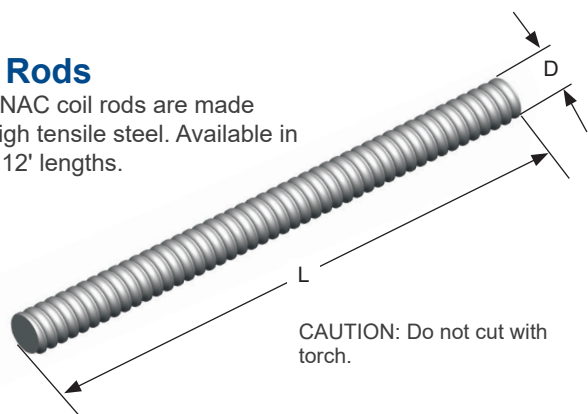

ITEM CODE	THREAD (D)	LENGTH (L)	TENSILE SWL (LBS)	SHEAR SWL (LBS)
CR 1/2 X 6'	1/2"	6'	3600	2400
CR 1/2 X 12'	1/2"	12'	3600	2400
CR 3/4 X 6'	3/4"	6'	7200	4800
CR 3/4 X 12'	3/4"	12'	7200	4800
CR 1 X 6'	1"	6'	15000	10000
CR 1 X 12'	1"	12'	15000	10000
CR 1-1/4 X 6'	1-1/4"	6'	22400	15000
CR 1-1/4 X 12'	1-1/4"	12'	22400	15000
CR 1-1/2 X 6'	1-1/2"	6'	27000	18000
CR 1-1/2 X 12'	1-1/2"	12'	27000	18000

Safe working loads based on approximate 5:1 Safety Factor.
Available in plain and plated finish.

Plastic Coil Protector

Looks like coil bolt. Use for keeping the coil clean during casting. Can be nailed to wood forms.

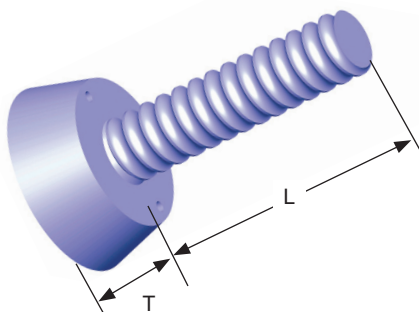

ITEM CODE	THREAD SIZE	T	L	COLOR	QUANTITY PER BOX
PCP-05	1/2" COIL	1/2"	2-1/4"	white	200
PCP-075	3/4" COIL	3/4"	3"	white	200
PCP-01	1" COIL	3/4"	4-1/2"	white	200

Coil Threaded Plastic Plugs

Can be nailed to wood forms.



ITEM CODE	THREAD SIZE	COLOR	QUANTITY PER BOX
TP4016C	1/2" COIL	lt. blue	100
TP4018C	3/4" COIL	dk. green	100

Coil Lifting System



Swivel Lifting Plates

Swivel Lifting Plates must be tightened securely and at full bearing for safe lifting usage. Safe working loads based on approximate 5:1 safety factor.

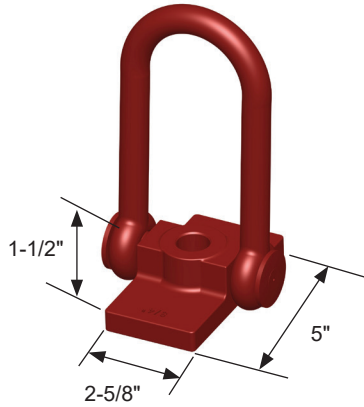

ITEM CODE	SIZE	MIN. BOLT LENGTH	SWL (LBS)
SWLP75	3/4"	4"	9000
SWLP10	1"	5"	9000

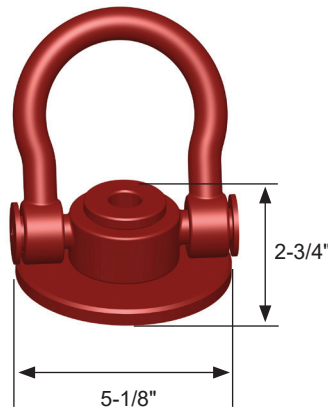

ITEM CODE	SIZE	MIN. BOLT LENGTH	SWL (LBS)
SWLP10-D	1"	5"	9000

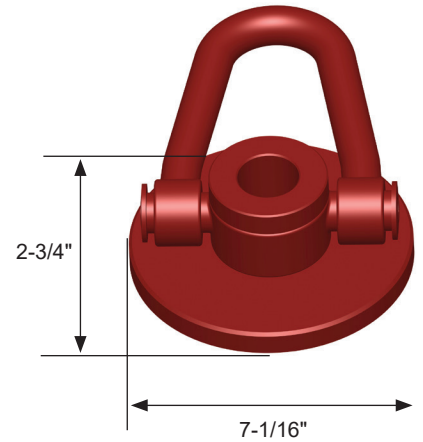

ITEM CODE	SIZE	MIN. BOLT LENGTH	SWL (LBS)
SWLP125-D	1-1/4"	6"	13500
SWLP150-D	1-1/2"	6"	13500

Coil Lifting Loops

Most economical lifting units for this system. Manufactured from flexible wire rope. For tension only - limited to 30 degrees from vertical. Galvanized cable loop with mill finished threaded stud.

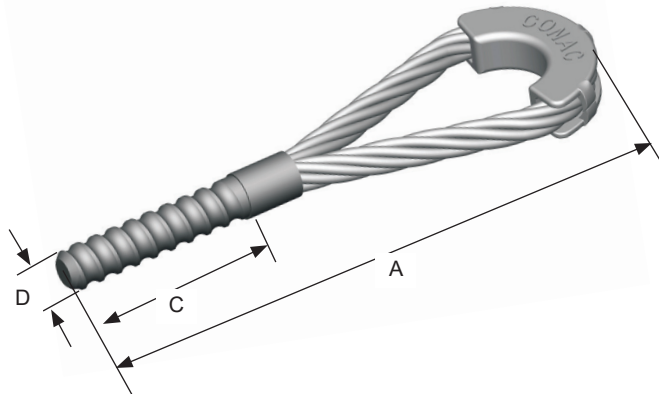

ITEM CODE	DIAMETER (D)	CAPACITY LOAD (LBS)	A	C
CLL50	1/2"	2000	5-1/2"	2-1/4"
CLL75	3/4"	5000	8-1/2"	2-3/4"
CLL100	1"	8000	10-3/4"	2-3/4"

Safe working loads based on approximate 5:1 Safety Factor.

Eye Bolt

Forged steel: one piece coil threaded eye bolt for connection only.

ITEM CODE	THREAD (D)	THREAD LENGTH (L)	OUTSIDE DIA. (A)	INSIDE DIA. (B)	SWL (LBS)
EYE BOLT 3/4X2	3/4"	2"	2-7/8"	1-1/2"	3600
EYE BOLT 1X2-1/2	1"	2-1/2"	3-1/2"	1-3/4"	6400

Safe working loads based on approximate 5:1 Safety Factor.

